

PROPOSED SECOND FLOOR

TOTAL AREA =

8-4-10
 For Proprietor
 Proprietor

BUILDING CONSTRUCTION FOR B. T. C. FACULTY AT
 RAM MANOHAR LOHIA MAHAVIDYALAYA
 SHANTI NAGAR LALUMOU, KHAJOORGANJ, RAIBARELY.

- for proposed
- for structure
- for execution

This drawing is the property of Architects Plus and is not to be reproduced, stored, transferred to a third party or used for any other purpose other than for which it has been issued.

NOTES:

1. NO DIMENSIONS TO BE SCALED OFF THE DRAWING.
2. ONLY WRITTEN DIMENSIONS TO BE FOLLOWED.
3. ANY DISCREPANCY FOUND IN THE DRAWING TO BE IMMEDIATELY GOT CLARIFIED WITH THE ARCHITECT OR HIS REPRESENTATIVE AT SITE.
4. ALL DRAWINGS ARE INTERRELATED AND SHALL BE READ IN CONJUNCTION WITH OTHER DRAWINGS.

REVISION	DEALT BY	DRAWING TITLE	Architects anupam mittal shubhra mittal Ph. No. 2205400 2209800 E-mail: resplend@architectsplus.com Address 1st floor, Aakash II, Oba, FFCO 31, Gokhale Niorg, Lucknow Tel: 2209800
	CHECKED BY		
	LOCATION		
	DATE		
	april 15 2010	FIRST FLOOR	Architects plus
		DRAWING NO.	
		H/2003/DP/PRE/5/01	

बजारा भव-शा ग्राम आलूमक पञ्चम उलाक तहकील लावगंला जिल्ला बागेश्वरी

लाकशील तह किलेट्तर शाग

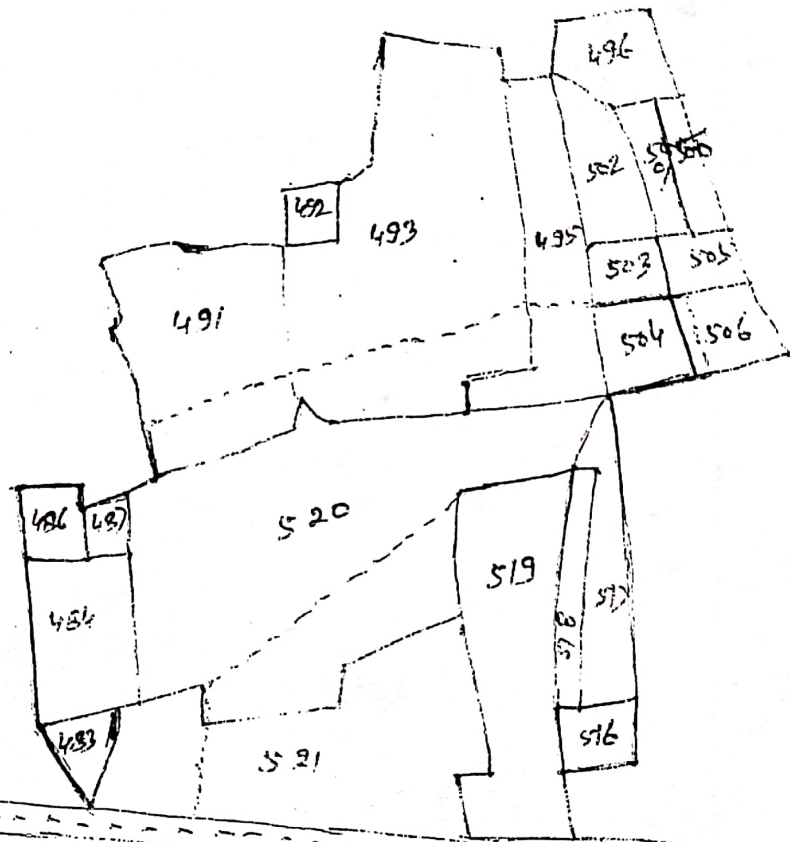

पञ्चम उलाक भवविद्यालय एवं क्वैदिलज हेड

सत्यापित

सहायक जमीन कार्यालय
बागेश्वरी-बागेश्वरी

31

दिनांक

२८-७-१२